

LINE **PC-13** S. P. 232 S. P. 100
 1200% DBS TVF

C.P.I. Permit PORTOCANNONE **WESTERN**
 COMPAGNIA PETROLIFERA ITALIANA S.p.A. Area: MOLISE **RICERCA**
GEOFISICHE S.p.A.

RECORDING DATA	PLAYBACK DATA
SHOT BY: O.G.S.	SAMPLE RATE: 4 ms
PARTY: DFS III	N SAMPLE TRACE: 1250
MAGNETIC RECORDER: BINARY	WEATHERING VEL. m/sec
GAIN: 2 m.s.	SUBWEATHERING VEL. 2000 m/sec
SAMPLE RATE: 6000 m.s.	DATUM PLANE: SEA LEVEL
RECORD LENGTH: 82 c.p.s.	Scale (VERTICAL 1 Sec. 10 cm)
FILTER (HI): 8 c.p.s.	(HORIZONTAL 1 Km. 5.67 cm)
ALIASING FILTER	PREPROCESSOR REEL No. 77431
SUBSURFACE COVERAGE: 1200%	STACK REEL No. 8885
DATE: JULY, 1975	DATE: MARCH, 1978

FIELD DATA	SKETCH
SPREAD CONFIGURATION: 262-3787 m.	NS: 3525, SP: 262
GROUPS / INTERVAL: 75 m.	
GEOPHONES / GROUP: 24 No.	
GEOPHONES FREQUENCY: 10 c.p.s.	
ENERGY SOURCE: EXPLOSIVE	
SHOT HOLES / S.P.:	
AVERAGE CHARGE / SHOT: 8 Kg.	
AVERAGE SHOT / DEPTH: 18 m.	
ENERGY SOURCE:	

PROCESSING SEQUENCE

- 1) EDIT
 - 2) PREPROCESSOR
 - 3) DECONVOLUTION BEFORE STK

PREDICTIVE DECON TIME DOMAIN :	
No. OF WINDOWS	4
MIN. PREDICTION DISTANCE	24 ms
OPERATOR LENGTH	136 -
 - 4) STATIC CORRECTIONS - BEFORE NMO - CDP METHOD
 - 5) VELOCITY ANALYSIS
 - 6) DYNAMIC CORRECTIONS - STRAIGHT RAY
 - 7) RESIDUAL STATIC CORRECTIONS
 - 8) COHERENCY STK
 - 9) TIME VARIANT FILTER (SEE GRAPH)
 - 10) REFORMAT
- NOTE

▽ VELOCITY FUNCTION CHANGE

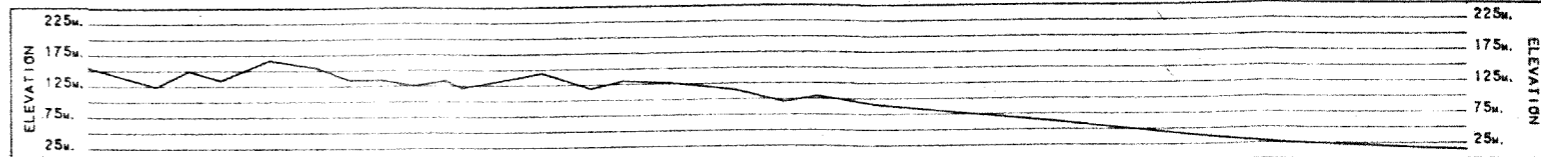
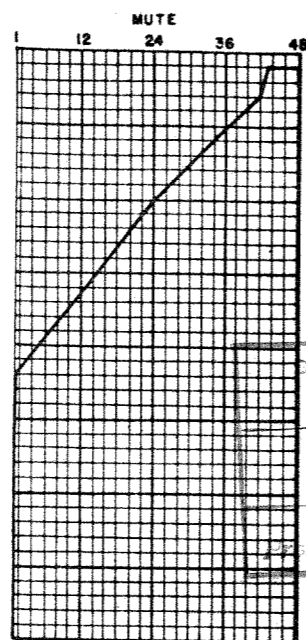
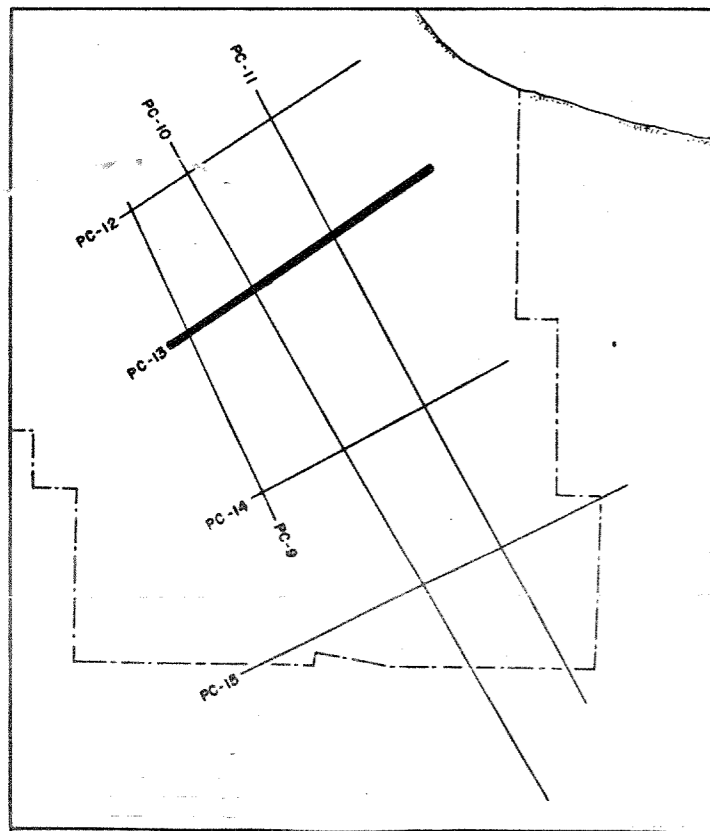

TIME	VEL	TIME	VEL	TIME	VEL
0.100	2000	0.100	2000	0.100	2000
0.400	2150	0.900	2200	0.900	2200
1.300	2500	1.300	2400	1.200	2300
1.500	2750	1.500	2700	1.500	2600
1.800	3000	1.800	3000	1.800	3000
2.200	4200	2.200	4300	2.200	4100
2.800	4700	2.800	4700	2.800	4900
4.000	5000	4.000	5000	4.000	5100

