

REPROCESSING  
 LINE CH-459-84 2300 FOLD S.P. 123 S.P. 304  
 STACK  
 D.B.S.-T.V.F.

**Agip**  
 HYDROCARBON EXPLORATION  
 GEOPHYSICAL EDP CENTRE  
 AREA ITALIA ZONA-4  
 PROSPECT BOSCO LE FRATTE

RECORDING DATA		PLAYBACK DATA	
CONTRACTOR	GLOBE EXPLORATION	DATUM PLANE	SEA LEVEL
PARTY NO	GLOBE-4	VERTICAL SCALE	1 SEC = 10 CM
RECORDING INSTRUMENT	SEG-B	HORIZONTAL SCALE	1 : 12500
SAMPLE RATE	2 MS	POLARITY CONVENTION	SEISMIC
RECORD LENGTH	7 SEC	PREPROCESSING REEL	605590
FILTER L.C.	10HZ-240B/OCT	STACK REEL	605600
ALIASING FILTER	106.7HZ-800B/OCT	MIGRATION REEL	605600
DATE	NOVEMBER, 1984	PREVIOUS PROCESSING	WESTERN R.G., 1985
SPREAD CONFIGURATION	1900-20-0-20-1900		
TRACE / S.P.	96		
GROUP / INTERVAL	40 M		
GEOPHONES / GROUP	18		
GEOPHONES / HZ	SM.48 10 HZ		
ENERGY/SOURCE	EXPLOSIVE		
SHOT HOLES/SP	1		
AVG. CHARGE SHOT	12 KG		
AVG. SHOT DEPTH	25/30 M		

PROCESSING

INPUT FORMAT: SEG B  
 EDIT FLOATING POINT  
 TIME SAMPLING 2 TO 4 MS.  
 NOISE SUPPRESSION  
 INSTRUMENT DEPHASING: MINIMUM PHASE  
 AMPLITUDE RECOVERY: GEOM. SPREADING  
 PREPROCESSOR  
 D.B.S.: PREDICTIVE TYPE  
 PREDICTION INTERVAL 32 MS  
 OPERATOR LENGTH 180 MS  
 3 WINDOW W.L. 12  
 AUTOMATIC STATICS SURFACE CONSISTENT  
 CDP COMPONENT INTERPOLATION  
 TRIDIMENSIONAL FILTER  
 D.M.O. CORRECTIONS  
 VELOCITY ANALYSIS  
 N.M.O. CORRECTIONS  
 COHERENCY STACK 23-FOLD (3/4 TR/WND)  
 MINIMUM TO ZERO PHASE CONVERSION  
 TIME VARIANT FILTER  
 TIME VARIANT EQUALIZATION (256-1024)

T.V.F. PARAMETERS
14HZ 24DB 55HZ 48DB
10HZ 24DB 50HZ 48DB
8HZ 24DB 45HZ 48DB
8HZ 24DB 45HZ 48DB

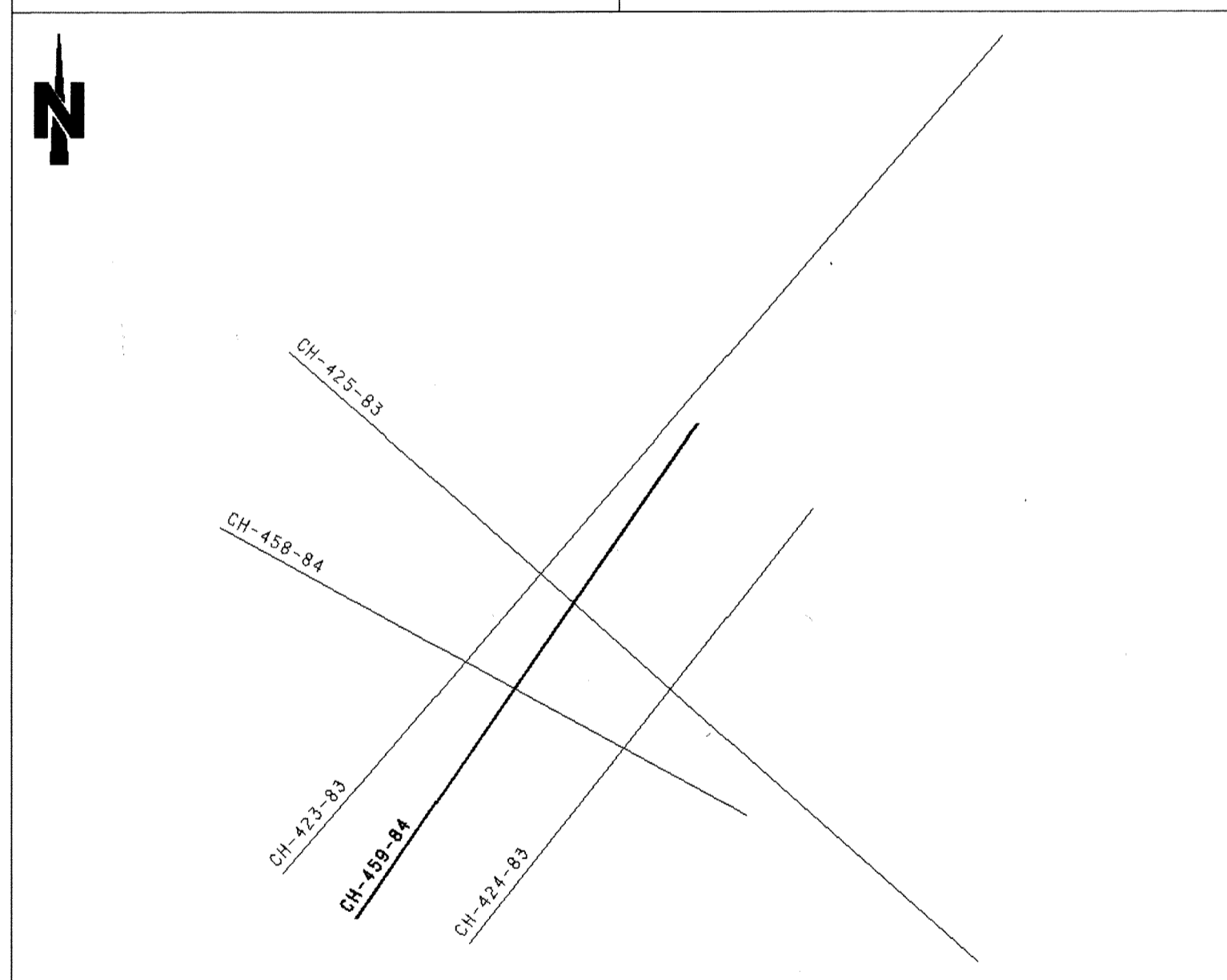

DATE JULY, 1988  
 PROCESSED BY A. BETTI E. STOLF  
 CONTROLLED BY A. TAGLIACARNE

