

SEZIONE IDROCARBURI  
di ROMA  
16 AGO. 1989  
Prot. N. 2811

A 2460

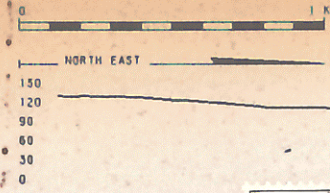

LINE CH-502-88 1500 FOLD S.P. 117 S.P. 261

MIGRATION-T.V.F.

Allegato <b>4</b>	Data GIUGNO 1989	Dis. n. 602/14
-------------------	---------------------	-------------------



AREA ITALIA ZONA-4  
PROSPECT PUNTA DELLA PENNA

RECORDING	DATA	PLAYBACK	DATA
CONTRACTOR PARTY NO RECORDING INSTRUMENT SAMPLE RATE RECORD LENGTH FILTER L.C. ALIASING FILTER DATE	C.G.G. 127 35 61 SH 348 2 MS 7 SEC 12.5HZ 1200/0CT 125HZ-7200/0CT JUNE, 1988	DATUM PLANE VERTICAL SCALE HORIZONTAL SCALE POLARITY CONVENTION PREPROCESSING REEL STACK REEL MIGRATION REEL PREVIOUS PROCESSING	SEA LEVEL 1 SEC - 5 CM 1 : 25000 SEISMIC 605726 605728 605728
SPREAD CONFIGURATION TRACE / S.P.	1770-15-0-15-1770 120		1 60 SP 61 120 --1770M--15M--15M--1770M--
GROUP / INTERVAL GEOPHONES / GROUP GEOPHONES / HZ	50 M 27 SM4 10 HZ		
ENERGY/SOURCE SHOT HOLES/SP AVG. CHARGE SHOT AVG. SHOT DEPTH	EXPLOSIVE 1 5/10 KG 50 M		

PROCESSING

INPUT FORMAT: SEG B  
EDIT FLOATING POINT  
TIME SAMPLING 2 TO 4 MS.  
INSTRUMENT DEPHASING: MINIMUM PHASE  
AMPLITUDE RECOVERY: GEOM. SPREADING  
PREPROCESSOR  
D.B.S.: PREDICTIVE TYPE  
PREDICTION INTERVAL 4 MS  
OPERATOR LENGTH 100 MS  
3 WINDOW W.L. 3Z  
AUTOMATIC STATICS SURFACE CONSISTENT  
VELOCITY ANALYSIS  
AUTOMATIC STATICS SURFACE CONSISTENT  
D.M.O. CORRECTIONS  
STACK 15-FOLD  
MINIMUM TO ZERO PHASE CONVERSION  
TIME MIGRATION: FINITE DIFFERENCE  
TIME VARIANT FILTER  
TIME VARIANT EQUALIZATION (256-1024)

T.V.F. PARAMETERS

16HZ 240B 70HZ 40DB  
16HZ 240B 65HZ 40DB  
10HZ 240B 60HZ 40DB  
8HZ 240B 40HZ 40DB

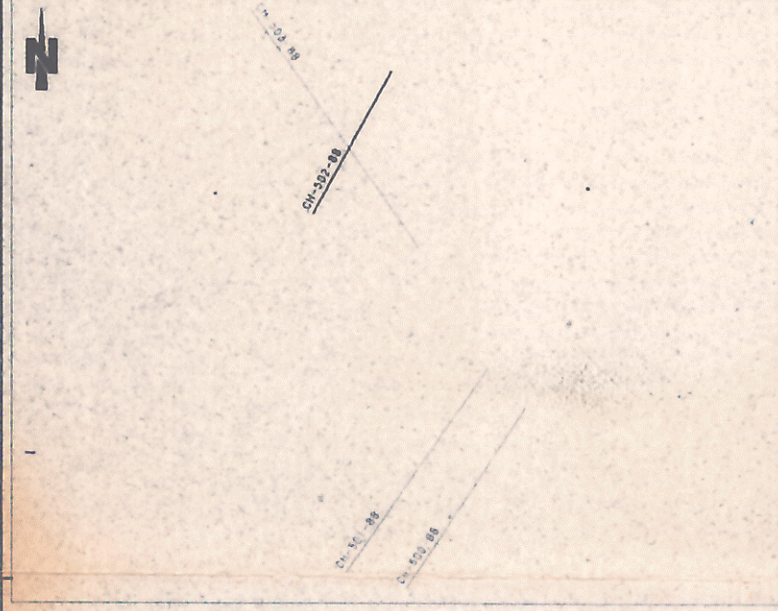

DATE OCTOBER, 1988  
PROCESSED BY A. BETTI E. STOLF  
CONTROLLED BY A. TAGLIACARNE

