

DATA OTTOBRE 1980 DIS N 270/2 ALLEGATO 2

LINE SA-322-79 S.P. 648 S.P. 815

1000% DBS - TVF REFERENCE 160180

Agip

AREA ITALIA - ZONA 4
PROSPECT PALINURO
WESTERN RICERCHÉ GEOFISICHE S.p.A.

RECORDING DATA PLAYBACK DATA

SHOT BY PART: PRAKLA IT IX
MAGNETIC RECORDER DFS IV
GAIN IFP
SAMPLE RATE 2 ma.
RECORD LENGTH 7000 ma.
FILTER HI 124 Hz.
LOW 12 Hz.
ALIASING FILTER Hz.
SUBSURFACE COVERAGE 1000%
DATE OCTOBER 1979

SAMPLE RATE 4 ma.
RECORD LENGTH 6000 ma.
AMPLITUDE 17
WEATHERING VEL. 500-850 m/sec
SUBWEATHERING VEL. 3400-3700 m/sec
DATUM PLANE SEA LEVEL

Scale VERTICAL 1 Sec 10 cm
HORIZONTAL 1 Km 8 cm

PREPROCESSOR REEL No 70042
STACK REEL No 72483
DATE JANUARY 1980

FIELD DATA SKETCH

SPREAD CONFIGURATION 1160-20-0-20-1160 m.

ENERGY SOURCE DYNAMITE
SHOT HOLES / SP 1
AVERAGE CHARGE / SHOT 4-16 Kg.
AVERAGE SHOT DEPTH 30-36 m.

GEOPHONE PATTERN 4-1
GROUP INTERVAL 40 m.
GEOPHONES / GROUP 36
GEOPHONE FREQUENCY 10 Hz.

PROCESSING

TRANSCRIPTION RESIDUAL STATICS
EDIT DEMULTIPLEX ONLY MANUAL
X EDIT GEOPHONE AMPLITUDE X SURFACE CONSISTENT
CORRELATION X CDP METHOD
X PRE-PROCESSOR X STACK
WEIGHTED STACK
DYNAMIC CORRECTION SPECIAL GAIN ROUTINE
X STRAIGHT RAY X SPECIAL MUTE
CURVED RAY MULTICHANNEL FILTER (PASS)
MULTICHANNEL FILTER (REJECT)
MIGRATION
X STATIC CORRECTIONS DEPTH CONVERSION
X PRELIMINARY STACK
X 100% CORRECTED
X VELOCITY ANALYSIS DISTANCE DEPENDENT MUTE
CONTINUOUS VELOCITY ANALYSIS

PREDICTIVE TIME DOMAIN DECON
X BEFORE STACK PREDICTION DISTANCE OPERATOR LENGTH NO WINDOWS
AFTER STACK 24 160 3

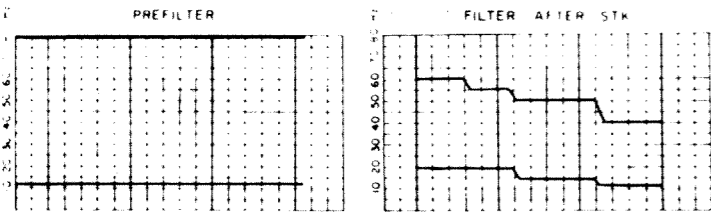

VELOCITY FUNCTION CHANGE INTERSECTION VELOCITY ANALYSIS LOCATION

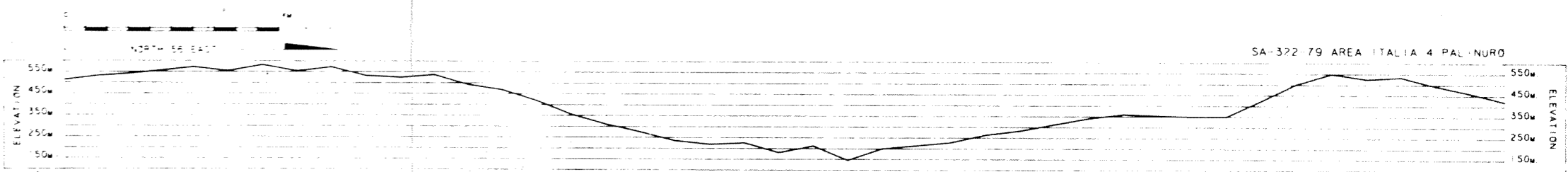
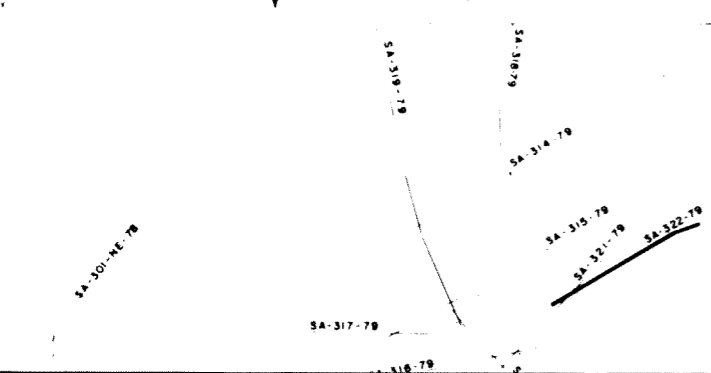

TIME	RMSV	TIME	RMSV
0.100	3300	0.100	3200
0.300	3800	0.300	3800
0.700	4000	0.700	4000
1.100	4400	1.100	4300
1.700	4600	2.400	4700
2.400	4800	3.500	5000
2.900	5000	6.000	5200
6.000	5200	0.210	0
0.155	0		

ISPANI 1

(Proiettato 2,2 Km S-SE)

